



ABOUTBLU/REGULAR

ASEPTIC & FOOD

**LUCERNA**

25026 00-A

S2 FO SR ESD  
EN ISO 20345:2022



**UPPER** washable, elastic, breathable and water-repellent, microfiber. Resistant to laceration, traction and chemical agents

**LINING** Antibacterial

**INSOLE** **AIR BIENCE** Thermoformed. Runresistant, multi-layered, antistatic latex-foam fabric, that is antibacterial, breathable and absorbent with anti-fungus activated carbons. Extractable. The sanitized treatment ensures the anti-bacterial aspect and the control of unpleasant odors.

**SOLE** **PU/PU DUAL DENSITY BASF PUR Elastopan®** polyurethane foam insole, ensures the maximum comfort and the absorption of the impact on all surfaces. Polyurethane outsole, with an elevated grip, resistant to wear, oils and hydrocarbons. System of energy absorption on the heel. It leaves no mark on the surface.

**TOE CAP** Steel (200J.)

**ANTI-TORSION SUPPORT** **COMPOSHANK** Anti-torsion support in ABS. It is applied between the antiperforation midsole and the midsole, corresponding to the arch of the foot. It improves stability on ladders, where foot support is not complete.

**WEIGHT SIZE 42** 450 gr

**SIZE** 35-48

**AIR BIENCE**



**FEATURES**

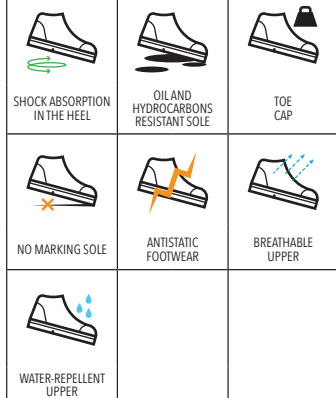

**PLUS**



**TECHNOLOGIES**

